

# Soils Map

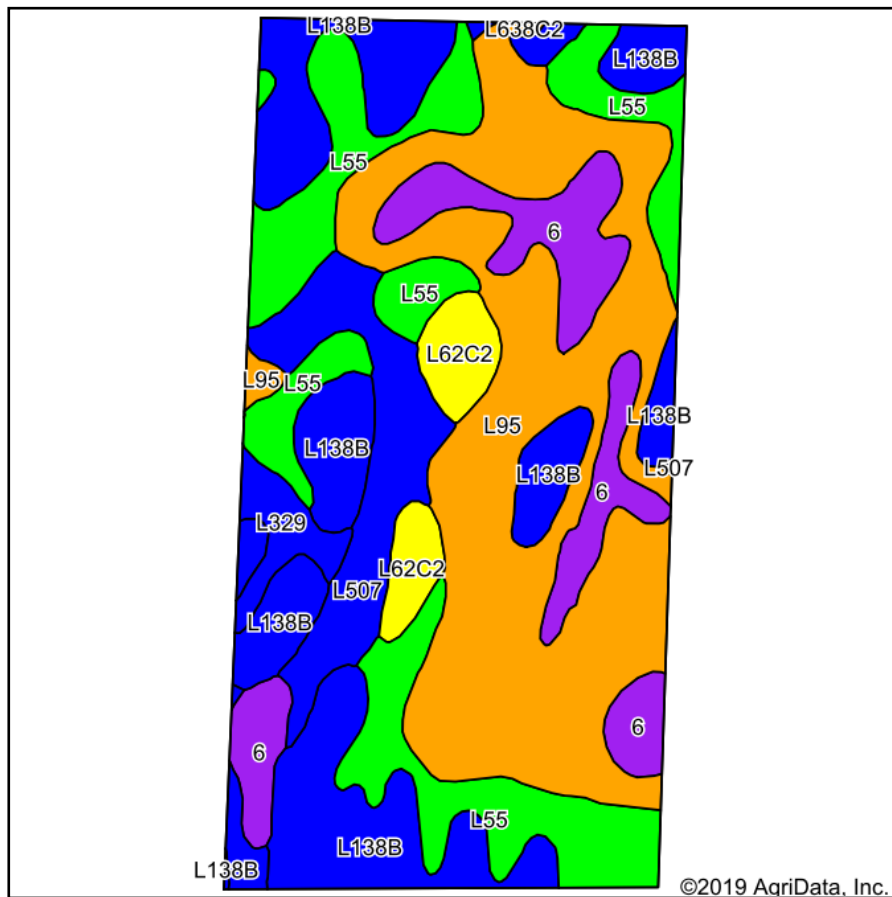

Soils data provided by USDA and NRCS.

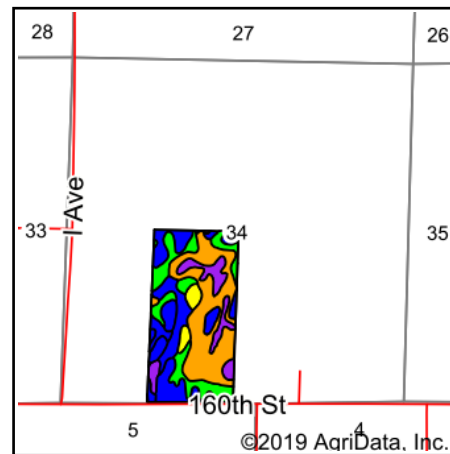

State: **Iowa**  
 County: **Hardin**  
 Location: **34-89N-21W**  
 Township: **Hardin**  
 Acres: **79.79**  
 Date: **10/10/2019**



Maps Provided By:



© AgriData, Inc. 2019

www.AgriDataInc.com



Area Symbol: IA083. Soil Area Version: 25								
Code	Soil Description	Acres	Percent of field	CSR2 Legend	Non-Irr Class *c	CSR2**	CSR	*n NCCPI Soybeans
L95	Harp clay loam, Bemis moraine, 0 to 2 percent slopes	26.60	33.3%		IIw	75		76
L138B	Clarion loam, Bemis moraine, 2 to 6 percent slopes	17.62	22.1%		Ile	88		79
L55	Nicollet loam, 1 to 3 percent slopes	15.32	19.2%		Ie	91		83
6	Okoboji silty clay loam, 0 to 1 percent slopes	8.54	10.7%		IIIw	59	59	77
L507	Canisteo clay loam, Bemis moraine, 0 to 2 percent slopes	6.39	8.0%		IIw	87		79
L62C2	Storden loam, Bemis moraine, 6 to 10 percent slopes, moderately eroded	2.87	3.6%		IIIe	64		63
L329	Webster-Nicollet complex, Bemis moraine, 0 to 3 percent slopes	2.36	3.0%		IIw	89		81
L638C2	Clarion-Storden complex, Bemis moraine, 6 to 10 percent slopes, moderately eroded	0.09	0.1%		IIIe	75		61
Weighted Average						80.2	*-	*n 78

\*\*IA has updated the CSR values for each county to CSR2.

\*- CSR weighted average cannot be calculated on the current soils data, use prior data version for csr values.

\*n: The aggregation method is "Weighted Average using major components"

\*c: Using Capabilities Class Dominant Condition Aggregation Method

Soils data provided by USDA and NRCS.